

model no. 058-9820-8

Mastercraft[®]

AIR-POWERED 3-IN-1 FLOORING NAILER

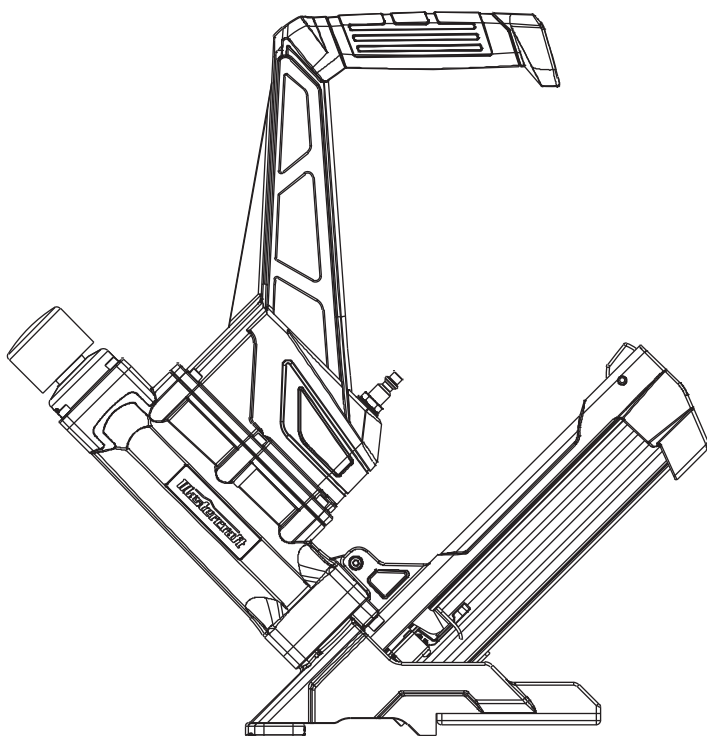

IMPORTANT:

For your own safety, read and follow all of the Safety Guidelines and Operating Instructions before operating this nailer. Keep this manual for future reference.

**OPERATING
MANUAL**

TABLE OF CONTENTS

TECHNICAL SPECIFICATIONS	4
SAFETY GUIDELINES	5
KEY PARTS DIAGRAM	9
TECHNICAL INFORMATION	10
TYPES OF NAILS	13
OPERATING INSTRUCTIONS	14
MAINTENANCE	19
TROUBLESHOOTING	20
EXPLODED VIEW	22
PARTS LIST	23
WARRANTY	24

TECHNICAL SPECIFICATIONS

LOADING CAPACITY	60 staples; 100 T- and L-cleats
FASTENER DETAILS	16-gauge T- and L- cleat (1 1/2 -2") 15.5-gauge flooring staple (1 1/2-2") with 1/2" widths
AIR CONSUMPTION	0.033 CF/cycle @ 90 PSI
APPLCATIONS	3/4" , 5/8" & 1/2" Tongue & Groove Solidwood flooring
NET WEIGHT	9 lb 14 oz (4.5 kg)
OPERATING PRESSURE	80-110 PSI (5.5-7.5 bar)

CF: Cubic Feet (the volumetric flow rate of air corrected to standardized conditions of temperature and pressure).
NPT: National Pipe Thread.

SAFETY GUIDELINES

This manual contains information that relates to PROTECTING PERSONAL SAFETY and PREVENTING EQUIPMENT PROBLEMS. It is very important to read this manual carefully and understand it thoroughly before using the product. The symbols listed below are used to indicate this information.

**DANGER!**

Potential hazard that will result in serious injury or death.

**WARNING!**

Potential hazard that could result in serious injury or death.

**CAUTION!**

Potential hazard that may result in injury or damage to equipment.

PERSONAL SAFETY

These precautions are intended for the personal safety of the user and others working with the user. Please take time to read and understand them. Make sure you read and understand this manual before using this tool. Make sure other users read and understand this manual before they use the tool.

Note: The word "Note" is used to inform the readers of something they need to know about the tool.

SAFETY GUIDELINES



- Do not use oxygen or any other combustible or bottled gas to power air-powered tools. Failure to observe this warning can cause explosion and serious personal injury or death. Use only compressed air to power air-powered tools. Use a minimum of 25' (7.6 m) of hose to connect the tool to only compressor. Failure to comply will result in serious injury or death.

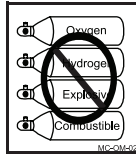

- Risk of inhalation:** Never directly inhale the air produced by the compressor.



- Risk of electric shock:** Do not expose a compressor to rain. Store it indoors. Disconnect the compressor from the power source before servicing. The compressor must be grounded. Do not use grounding adaptors.



- Risk of personal injury:** Do not direct compressed air from the air hose towards the user or other people or animal.



- Risk of burns:** The pump and the manifold generate high temperatures. In order to avoid burns or other injuries, do not touch the pump, the manifold, or the transfer tube while the compressor is running. Allow the parts to cool down before handling or servicing. Keep children and pets away from the compressor at all times.



- Risk of bursting:** Do not adjust the pressure switch or safety valve for any reason. They have been preset at the factory for this compressor's maximum pressure. Tampering with the pressure switch or the safety valve may cause personal injury or property damage.



- Risk of bursting:** Make sure the regulator is adjusted so that the compressor outlet pressure is set lower than the maximum operating pressure of the tool. Before starting the compressor, pull the ring on the safety valve to make sure the valve moves freely. Drain water from the tank after each use. Do not weld nor repair the tank. Relieve all pressure in the hose before removing or attaching accessories.

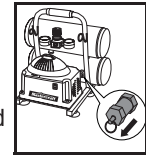

WARNING!

Potential hazard that could result in serious injury or loss of life.

- Do not allow inexperienced or untrained individuals to operate an Air-powered 3-in-1 Flooring Nailer or any other air-powered tool.
- Keep hands and other parts of the body away from the firing head during use. Keep hands, feet, and all other parts of the body at least 8" (20 cm) away from the firing head. Nails or objects in the workpiece can cause serious injury if they are deflected by the workpiece or if they are driven away from the point of entry.
- Do not overload the tool. Allow the tool to operate at its optimum speed for maximum efficiency.
- Locate the compressor in a well-ventilated area for cooling, at a minimum of 12" (30 cm) away from the nearest wall.
- Protect the air hose and the power cord from damage and puncture. Inspect them for weak or worn spots before every usage, and replace them if necessary.
- Always wear eye and hearing protection when using the air compressor. Failure to do so may result in hearing loss.
- Do not carry the compressor while it is running.
- Do not operate the compressor if it is not in a stable position.
- Do not operate the compressor on a rooftop or in an elevated position that could allow the unit to fall or be tipped over.
- Always replace a damaged gauge before operating the unit again.



DANGER!

Potential hazard that will result in serious injury or death.

- Keep children away from the work area. Do not allow children to handle power tools.
- Do not use this tool in the presence of flammable liquids or gases. Sparks that are created during use may ignite gases.
- Do not point the tool towards yourself or other people, even when the tool has stopped. Keep hands, feet, and all other parts of the body clear from work area.
- Do not attempt to clear nailer jams while the air hose is connected.
- Do not keep the trigger or the safety stand pressed while loading nails. Unintentional firing of a nail could cause serious personal injury or death.
- Do not disconnect or reconnect the air hose with the trigger pressed. The Air-powered 3-in-1 Flooring nailer may fire when it is reconnected to the air supply.

- Disconnect the tool from the air supply and turn off the compressor before performing any maintenance, loading or changing nails, when the tool is not in use, when it is being handed to another person, and when it is left unattended. Failure to comply may result in injury or damage to equipment.

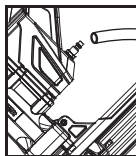

- Use safety goggles and ear protection:
Wear safety glasses with side shields when operating the tool and verify that others in the work area are also wearing safety glasses. Safety glasses must conform to American National Standards Institute (ANSI Z87.1) requirements and must provide protection from flying particles from the front and the sides. Air-powered tools are loud and the sound can cause hearing damage. Always wear ear protection to help prevent hearing damage and loss. Failure to comply may result in injury.

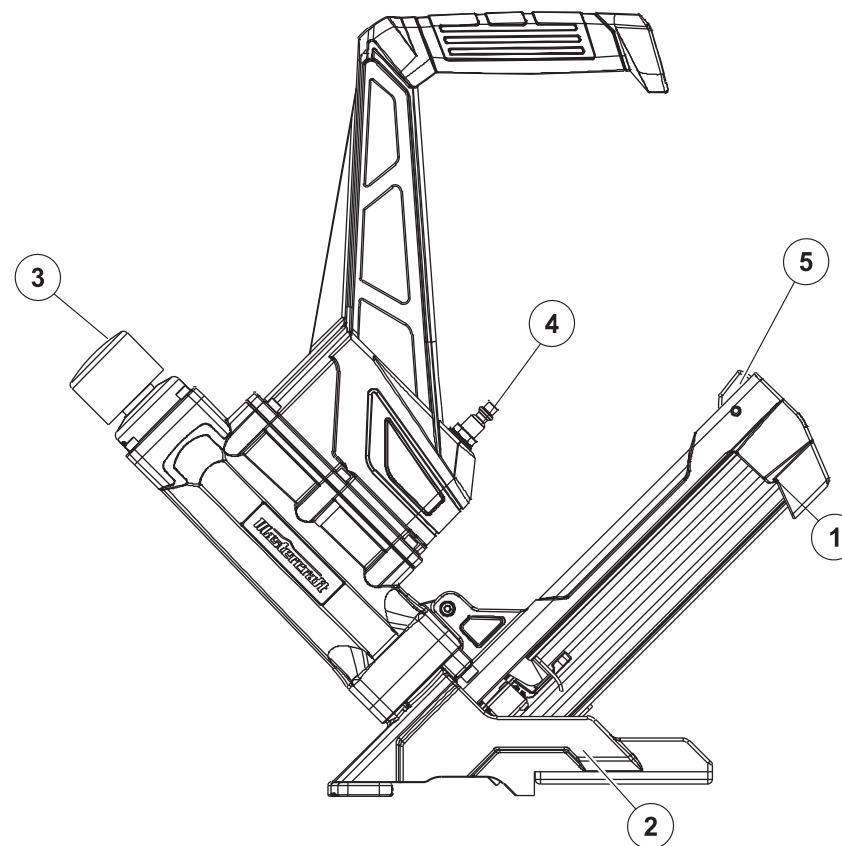

No.	Description	No.	Description
1	Magazine	4	Air inlet plug
2	Spacer base plate for depth control	5	Magazine pusher latch
3	Hammer striking area - whack cap		

**CAUTION!**

Potential hazard that may result in injury or damage to equipment.

Note: Recycle unwanted materials rather than disposing of them as waste. Sort the tools, hoses, and packaging in specific categories and take them to the local recycling centre or dispose of them in an environmentally safe way.

Compatible compressors

GUIDELINES FOR PROPER USE AND OPERATION

Be sure to use a proper air compressor with Mastercraft® Air-powered tools. The compressor should be able to supply a minimal air delivery of 4 CFM @ 90 PSI to ensure the compressor can run continuously with the Mastercraft® Air-powered 3-in-1 Flooring Nailer.

General use

This Mastercraft® Air-powered 3-in-1 Flooring Nailer drives 15.5 gauge staples 1 1/2 to 2" (38 to 50 mm) long with a 1/2" (12.7 mm) crown, and 16-gauge "L&T" shaped cleats and nails that are between 1 1/2 and 2" (38 and 50 mm) in length. It features a heat treated die-cast aluminum housing and a comfortable handle for optimal control and comfort, even during extended use. It is well balanced for stability, and ergonomically designed with a longer handle for ease of operation. It also features a hardened driver blade for longer life, a composite base plate to eliminate scratches and damage to surfaces, and economical air consumption with low noise. This Air-powered 3-in-1 Flooring Nailer is specifically designed for installing hardwood flooring.

Air Compressor Size and Power	1 1/2-2 HP	2 1/2 HP	3+ HP
4-5 Gallons	Light-duty and intermittent use	Light-duty and intermittent use	Light-duty and intermittent use
6-11 Gallons	Light-duty and intermittent use	Medium-duty and intermittent use	Medium-duty and intermittent use
15+ Gallons	Medium-duty and intermittent use	Heavy-duty and continuous use	Heavy-duty and continuous use

Wood Density	Nail Size	Compressor Air Pressure
>0.6 g/cm ³	<1 1/4" (32 mm) staples	90 PSI (6.2 bar)
	≥1 1/4" (32 mm) staples	120 PSI (8.3 bar)
	<1 1/2" (38 mm) L nails	90 PSI (6.2 bar)
	≥1 1/2" (38 mm) L nails	110 PSI (7.6 bar)
≤0.6 g/cm ³	<1 1/4" (32 mm) staples	75 PSI (5.2 bar)
	≥1 1/4" (32 mm) staples	110 PSI (7.6 bar)
	<1 1/2" (38 mm) L nails	75 PSI (5.2 bar)
	≥1 1/2" (38 mm) L nails	100 PSI (6.9 bar)

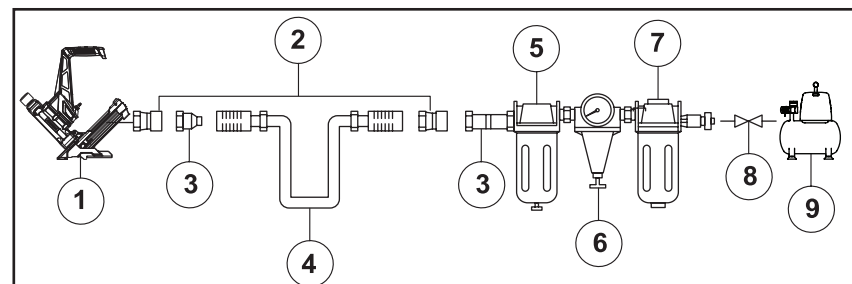

No.	Description	No.	Description
1	MASTERCRAFT® Air-powered 3-in-1 Flooring Nailer	6	Regulator (0 to 8.5 bar)
2	Quick connector	7	Filter
3	Quick coupler	8	Cut-off valve
4	Air hose	9	Air compressor
5	Lubricator		

Air system

- Always use clean, dry, regulated, compressed air at 4.8 to 7.5 bar (70 to 110 PSI).
- Do not exceed the maximum or minimum pressures. Operating the tool at the wrong pressure (too low or too high) will cause excessive noise or rapid wear.



WARNING!

Potential hazard that could result in serious injury or death.

- Keep hands and other parts of the body away from the tool's discharge and working areas when connecting the air supply. Failure to comply could lead to serious injury or death.

- It is recommended that a filter-regulator-lubricator be used and be located as close to the tool as possible.
- If a filter-regulator-lubricator is not installed, place up to 6 drops of compressor oil into the air inlet plug before each use.
- If a filter-regulator-lubricator is installed, keep the air filter clean. A dirty filter will reduce the air pressure to the tool, which will cause a reduction in power, efficiency, and general performance.
- For optimal performance, install a quick connector to the tool and a quick coupler on the hose, if applicable.
- Verify that all of the connections in the air supply system are sealed in order to prevent air leakage.

Read this Instruction Manual carefully before using the Air-powered 3-in-1 Flooring Nailer .

- Read and follow all the safety instructions at the beginning of this manual. Inspect the Air-powered 3-in-1 Flooring Nailer prior to each use in order to:
 - ensure that the proper power source is being used.
 - verify that the tool is in proper working order.

Types of Nails

Flooring staples (15.5 gauge)

Crown: 1/2" (12.7 mm)

Length: 1 1/2-2" (38-50 mm)

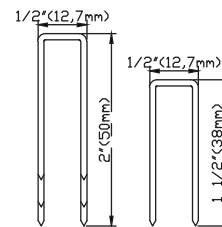

T-Shaped cleats /nails (16 gauge)

Length: 1 1/2-2"

(38-50 mm)

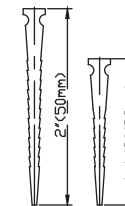

L-Shaped cleats/

nails (16 gauge)

Length: 1 1/2-2"

(38-50 mm)

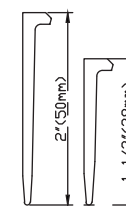

NAIL TYPE ICON

These icons are used to select the proper nails for this specific nailer.



NAIL SIZE:
TAILLE:
1 1/2-2"



NAIL SIZE:
TAILLE:
1 1/2-2"

Note: Icons are colour coded. Please refer to the actual tool for the specific colour.



WARNING!

Potential hazard that could result in serious injury or death.

- The use of any other types of nails will cause the nailer to jam and could lead to serious injury or death.

WARNING!

Potential hazard that could result in serious injury or death.

- Do not use the tool if it is not in proper working order.
- Do not use oxygen or any other combustible or bottled gas to power this tool.
- Do not use this tool in the presence of any flammable liquids or gases.
- Keep hands and other parts of the body away from the firing head during use.
- Do not point the tool towards the operator or other people.
- Do not attempt to clear a jammed nail when the air hose is connected.
- Do not drive a nail on top of an existing nail. Failure to comply could lead to serious injury or loss of life.

Loading nails

1. Disconnect the tool (1) from the air supply (2) (Fig. A).

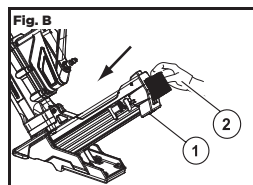
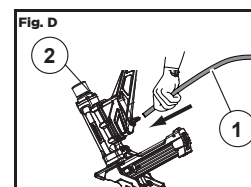
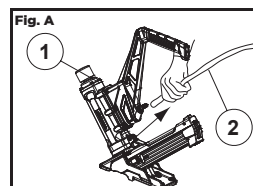

2. Take hold of the Air-powered 3-in-1 Flooring Nailer firmly with one hand. Use the other hand to press the pusher latch (1) on the magazine and slide it back. Make sure you have the right nails for your tool (See page 13). Insert a strip of fasteners (2) into the magazine. Ensure that the points of the fasteners are facing down (Fig. B).

3. Release the pusher (1), so that it rests on against the fasteners (2) to close the magazine, until it comes into contact with the fasteners and locks into position (Fig. C).

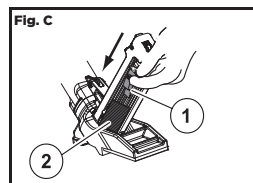

5. Hold the handle, and lift the Air-powered 3-in-1 Flooring Nailer into place. Swing the mallet and strike the top end of the "whack cap" with the rubber face of the mallet (Fig. E).

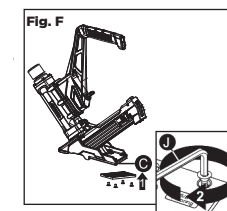
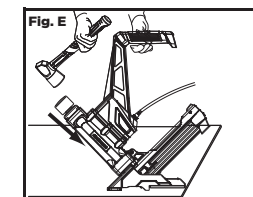

6. Using the hex key (J), hold the nailer upside down and remove the four screws from the base plate by turning counter clockwise. Attach the desired plate (See Fig. F). Ensure the screw holes on the base plate line up with the holes at the nailer base (C). Tighten the screws by turning clockwise (See Fig. F). Make sure screws do not protrude out of the base plate.

**DANGER!**

Potential hazard that will result in serious injury or death.

- Disconnect the tool from the compressed air source before loading nails.
- Do not point the tool towards the operator or other people while changing nails.
- Do not hold the tool with the trigger pressed while changing nails. Failure to comply will lead to serious injury or death.

INSERTION METHODS

The Air-powered 3-in-1 Flooring "L&T" cleats and staples, which are to be inserted using different insertion methods.

1. "L&T" cleats: Insert the cleats (1) from the top area of magazine into the centre slot at the top of the magazine (Fig. G).

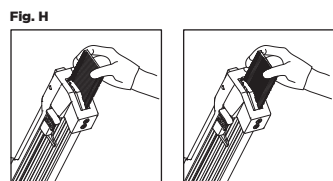
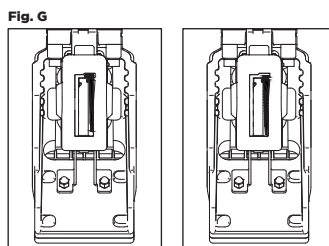

2. Staples: Insert the staples (1) from the top area of the magazine with one arm of the staple in the centre slot of the magazine and the other arm along the left side of the magazine (Fig. H).

Clearing a jammed fastener

To clear a jammed fastener:

- Disconnect the tool from the air supply line.
- Remove the fasteners that are stored in the tool's magazine.
- Use pliers or any appropriate tool to remove the jammed fastener.
- Reload the fasteners into the tool magazine.
- Reconnect the air line to the tool's air inlet.
- Test fire 3 to 5 fasteners into a piece of scrap wood in order to ensure proper operation.

1. Pull the pusher latch to the end of the magazine to lock it (Fig. I).

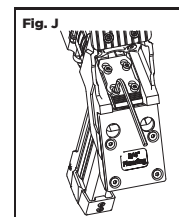
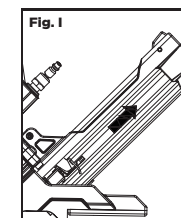

2. Using the hex key, hold the gun upside down and loosen the four screws from the cover plate by turning counter clockwise (Fig. J).

3. Pull out and lift up the cover plate. Remove it to clean the jam (Fig. K&L).

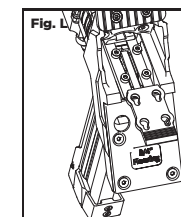
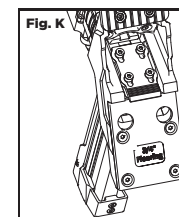

WARNING!

Potential hazard that will result in serious injury or death .

- The safety tip must be in contact with the workpiece before activating the tool.
- Do not operate the tool if the nails are not loaded, as doing so may damage the tool.
- Do not fire nails into the air, as doing so may cause injury to the operators or others, apart from damaging the tool.
- Load the correct type of nails only. Failure to comply could lead to serious injury or loss of life.



CAUTION!

Potential hazard that may result in moderate injury or damage to equipment.

- Operate the tool with utmost care when connected with the air compressor . Failure to comply may result in moderate injury or damage to equipment.

Clearing a jammed nail

To clear a jammed nail

- Disconnect the tool from the air supply line.
- Remove the non-jammed nails that are stored in the tool's magazine.
- Operate the magazine latch and slide the pusher back to open the magazine for checking the jammed nails.
- Use pliers or any appropriate tool to remove the jammed nails.
- Close the magazine cover and slide the pusher to its original position.
- Reload the nails into the tool magazine.
- Reconnect the air supply line to the tool's air inlet.
- Test fire 3 to 5 nails into a piece of scrap wood in order to ensure a proper operation.

Cold weather operation

When operating any air-powered tool below freezing temperature:

- Verify if the compressor tank has been properly drained prior to use.
- Keep tools as warm as possible using any safe, convenient method.
- Place up to 6 drops of pneumatic tool oil into the tool's air inlet.
- Adjust the air pressure to 80 PSI or lower.
- Load the nails into the magazine (if required).
- Actuate the tool 5 to 6 times into a scrap wooden piece in order to lubricate the O-rings.
- Adjust the air pressure to the operating level (do not exceed 120 PSI) and use the tool normally.
- Relubricate the tool, as described in the maintenance section.
- Drain the compressor tank at least once per day.

Note: If the nails continue to jam, call 1-800-689-9928.



WARNING!

Potential hazard that will result in serious injury or death .

- Disconnect the tool from the air supply line before clearing a jammed nail. Failure to comply could cause them to be fired out of the tool causing serious injury.
- Do not point the tool towards the operator or other people. Serious personal injury could result if these instructions are not followed.

Maintenance

MAINTENANCE REQUIRED	DESCRIPTION	TOOLS OR MATERIALS REQUIRED	MAXIMUM SERVICE INTERVAL		
			Each Use or every 2 Hrs	Monthly	As Needed
General inspection-free movement	Trigger, spring, safety mechanism	None	X		
In-depth inspection	Worn or broken parts			X	X
Replace worn or broken parts					X
Lubrication	See below	Pneumatic tool oil	X		

- Lubrication: If the Air-powered 3-in-1 Flooring Nailer and the compressor are not equipped with an in-line lubrication system, place up to 6 drops of pneumatic tool oil into the air inlet before each work day or after every 2 hours of continuous use, depending on the characteristics of the workpiece and type of fasteners used.

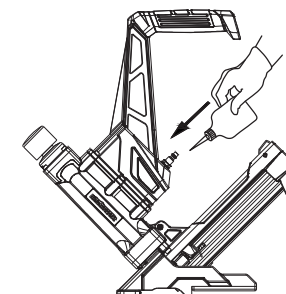

- Air-operated tools must be inspected periodically and worn or broken parts must be replaced to ensure that the tools are operating safely and efficiently.
- Inspect and replace worn or damaged O-rings, seals, etc. Tighten all screws and caps frequently in order to help prevent personal injury.
- Keep the magazine of the tool clean and free of any dirt or abrasive particles.

Note: When temperatures are below freezing, keep the tools warm using any safe, convenient method.



DANGER!

Potential hazard that will result in serious injury or death .

- Disconnect the tool from the air compressor before performing maintenance/service, adjusting, clearing jams, reloading, and when it is not in use.
- Repairs must be performed by a qualified service technician only. Failure to comply will lead to serious injury or death.

Troubleshooting

The following chart lists common issues and solutions. Please read it carefully and follow all instructions carefully. Disconnect the tool from the air supply before making any adjustments.

PROBLEM	POSSIBLE CAUSES	SOLUTIONS
Air leakage at the top of the tool or in the trigger area.	<ol style="list-style-type: none"> O-rings in the trigger valve are damaged. The trigger valve heads are damaged. Trigger valve stem, seal, or O-rings are damaged. 	<ol style="list-style-type: none"> Inspect and replace the O-ring. Inspect and replace trigger valve heads. Inspect and replace the trigger valve stem, seal, or O-ring. <p>Have the tool serviced by a qualified service technician.</p>
Air leakage near the bottom of the tool.	<ol style="list-style-type: none"> The screws are loose. The O-rings or the bumper are worn or damaged. 	<ol style="list-style-type: none"> Tighten the screws. Inspect and replace the O-rings or the bumper. <p>Have the tool serviced by a qualified service technician.</p>
Air leakage between the bottom and the cylinder cap.	<ol style="list-style-type: none"> The screws are loose. The O-rings or the seals are worn or damaged. 	<ol style="list-style-type: none"> Tighten the screws. Inspect and replace the O-rings or the seals. <p>Have the tool serviced by a qualified service technician.</p>
The nails are being driven too deep.	<ol style="list-style-type: none"> The bumper is worn. The air pressure is too high. The depth adjustment knob is not adjusted properly. 	<ol style="list-style-type: none"> Replace the bumper. Adjust the air pressure. Adjust the depth setting by turning the depth adjustment knob counterclockwise (see section "Adjusting nail depth" for more detailed instructions).

PROBLEM	POSSIBLE CAUSES	SOLUTIONS
The tool does not operate properly - it does not drive the nails or operates sluggishly.	<ol style="list-style-type: none"> The air supply is inadequate. Lubrication is inadequate. The O-rings or seals are worn or damaged. The exhaust deflector in the cylinder head is blocked. 	<ol style="list-style-type: none"> Verify that the air supply is adequate. Pour up to 6 drops of oil into the air inlet. Inspect and replace O-rings or seals. Replace the damaged internal parts. <p>Have the tool serviced by a qualified service technician.</p>
The tool skips nails.	<ol style="list-style-type: none"> The bumper is worn or the spring is damaged. There is dirt in the front plate. Nails cannot move freely in the magazine due to dirt or wear. The O-ring on the piston is worn or dry or lubrication is insufficient. The cylinder cover seal is leaking. 	<ol style="list-style-type: none"> Replace the bumper or spring. Clean the drive channel on the front plate. Clean the magazine. Replace the O-ring. Replace the sealing washer. <p>Have the tool serviced by a qualified service technician.</p>
The tool jams.	<ol style="list-style-type: none"> Improper nails are used, or nails are damaged. The driver guide is damaged or worn. The magazine screw is loose. There is dirt in magazine. 	<ol style="list-style-type: none"> Use proper nails. (see section "Clearing a jammed nail.") Inspect and replace the driver. Tighten the magazine. Open and clean the magazine.
Air exhaust is being directed towards the operator.	The direction of the exhaust deflector requires adjustment.	Direct the exhaust deflector away from the operator.



DANGER!

Potential hazard that will result in serious injury or death .

- If any of the following symptoms appear while the tool is in use, turn it off and disconnect it from the air supply immediately. Failure to comply will lead to serious injury or death.
- Repairs must be performed by a qualified service technician only.

Note: For further repair information, please call 1-800-689-9928.

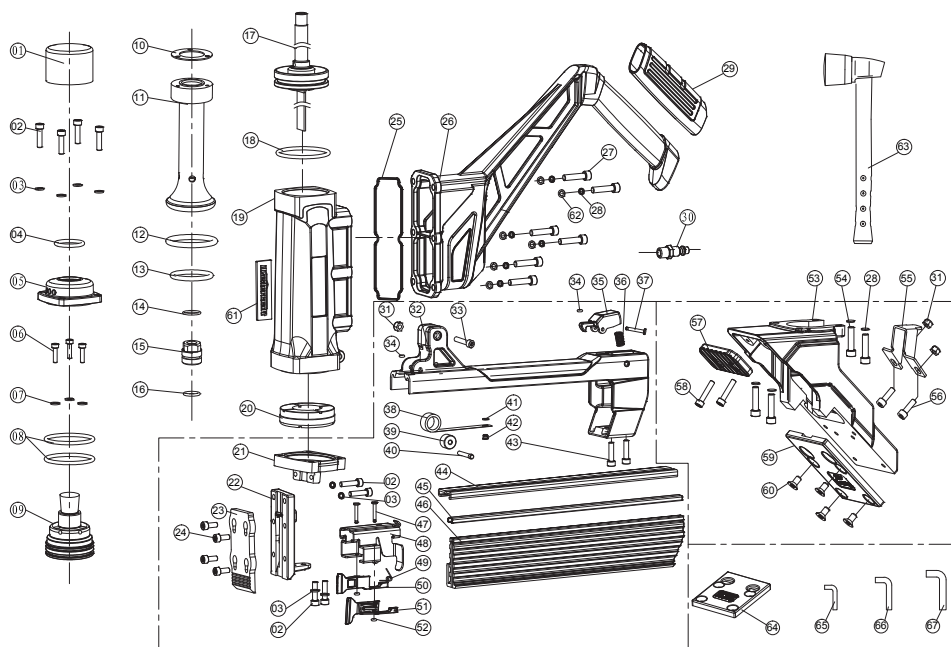

No.	Description	Qty.	No.	Description	Qty.
1	Whack cap	1	11	Piston sleeve	1
2	M5x20 Screw	8	12	O-ring 32 x 4.5	1
3	Washers D=5	8	13	O-ring 12.4 x 2.5	1
4	O-ring 25 x 3.55	1	14	O-ring 15.6 x 1.8	1
5	Cylinder cover	1	15	Nut	1
6	N4 x 16 Bolt	3	16	O-ring 12.8 x 1.8	1
7	Washers D=4	3	17	Piston assembly	1
8	O-ring 48.7 x 2.65	2	18	O-ring 50 x 3.55	1
9	Piston seat	1	19	Aluminum housing	1
10	Piston sleeve cover seal	1	20	Bumper	1

No.	Description	Qty.	No.	Description	Qty.
21	Cylinder seat	1	45	Nail guide	1
22	Driver guide plate	1	46	Magazine	1
23	Driver guide cover plate	1	47	Pin	2
24	M6 x 12 Screws	4	48	Pusher seat	1
25	Handle gasket	1	49	Pusher spring	2
26	Handle	1	50	Right pusher	1
27	M6 x 25 Screws	6	51	Left pusher	1
28	Washer	10	52	O-ring 1.2 x 1.5	2
29	Hand grip	1	53	Base (shoe)	1
30	1/4 NPT 18 Air inlet plug	1	54	M6 x 40 Screws	4
31	Self locking nut	3	55	Bracket	1
32	Magazine cover	1	56	M5 x 14 Screws	2
33	M5 x 22 Screws	1	57	Front foot	1
34	O-ring 1.7 x 2	4	58	M5 x 18 Screws	2
35	Magazine pusher latch	1	59	3/4" base plate	1
36	Magazine pusher latch spring	1	60	M6 x 18 screws	4
37	Magazine pusher latch pin	1	61	LOGO	2
38	Magazine coil spring	1	62	Washer D=6	6
39	Coil spring core	1	63	Mallet	1
40	Coil spring pin	1	64	1/2" & 5/8" Base plate	1
41	Coil spring seal	1	65	M4 Hex key	1
42	Coil spring nut	1	66	M5 Hex key	1
43	M5 x 16 Screws	4	67	M6 Hex key	1
44	Pusher seat shelf	1			

3-Year Limited Warranty

This product is guaranteed for a period of 3 years from the date of original retail purchase against defects in workmanship and materials, except for the following component:

Component A: Accessories, which are guaranteed for a period of 1-year from the date of original retail purchase against defects in workmanship and materials.

Subject to the conditions and limitations described below, this product, if returned to us with proof of purchase within the stated warranty period and if covered under this warranty, will be repaired or replaced (with the same model, or one of equal value or specification), at our option. We will bear the cost of any repair or replacement and any costs of labor relating thereto.

These warranties are subject to the following conditions and limitations:

- a) A bill of sale verifying the purchase and purchase date must be provided.
- b) This warranty will not apply to any product or part thereof which is worn or broken or which has become inoperative due to abuse, misuse, accidental damage, neglect, or lack of proper installation, operation, or maintenance (as outlined in the applicable instruction manual or operating instructions), or which is being used for industrial, professional, commercial, or rental purposes.
- c) This warranty will not apply to normal wear and tear or to expendable parts or accessories that may be supplied with the product which are expected to become inoperative or unusable after a reasonable period of use.
- d) This warranty will not apply to routine maintenance and consumable items such as, but not limited to, fuel, lubricants, vacuum bags, blades, belts, sandpaper, bits, fluids, tune-ups, or adjustments.
- e) This warranty will not apply where damage is caused by repairs made or attempted by others (i.e., persons not authorized by the manufacturer).
- f) This warranty will not apply to any product that was sold to the original purchaser as a reconditioned or refurbished product (unless otherwise specified in writing).

- g) This warranty will not apply to any product or part thereof if any part from another manufacturer is installed therein or any repairs or alterations have been made or attempted by unauthorized persons.
- h) This warranty will not apply to normal deterioration of the exterior finish, such as, but not limited to, scratches, dents, paint chips, or to any corrosion or discoloring by heat, or abrasives and chemical cleaners.
- i) This warranty will not apply to component parts sold by and identified as the product of another company, which shall be covered under the product manufacturer's warranty, if any.

Additional limitations

This warranty applies only to the original purchaser and may not be transferred. Neither the retailer nor the manufacturer shall be liable for any other expense, loss or damage, including, without limitation, any indirect, incidental, consequential, or exemplary damages arising in connection with the sale, use, or inability to use this product.

Notice to consumer

This warranty gives you specific legal rights, and you may have other rights, which may vary from province to province. The provisions contained in this warranty are not intended to limit, modify, take away from, disclaim, or exclude any statutory warranties set forth in any applicable provincial or federal legislation.

Made in China

Imported by Mastercraft Canada Toronto, Canada M4S 2B8